

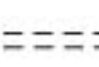

LEGEND:

-  MRT Line & Station
-  Under Construction/Future Road
-  Future North-South Expressway (NSE)
-  (u/c) Under Construction

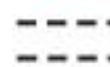

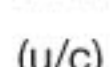
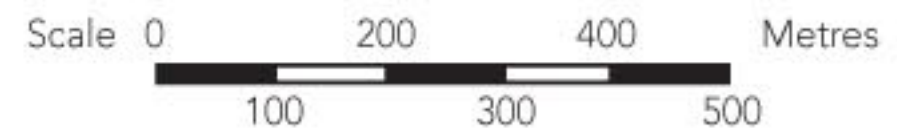

LEGEND

- 4-Room
- 5-Room
- Future Social Community Facilities (FSCF) at 2nd Storey/
Utility Centre (UC) at 1st Storey
- Trellis
- Precinct Pavilion / Drop-off Porch/ Shelter
- Children Playground (PG) /
Adult Fitness Station (AFS) / Elderly Fitness Station (EFS)
- Electrical Sub-Station at 1st Storey (ESS)
- Driveway
- Open Space at 1st Storey
- Open Space at 2nd Storey Landscape Deck
- Ramp
- Staircase
- Drainage Reserve
- Reserved for/ Existing Development
- Centralised Refuse Chute
- Corridor
- Lift
- Service Bay

BLOCK NUMBER	NO. OF STOREYS	4 ROOM	5 ROOM	TOTAL	LIFT OPENS AT
121A	15	65	39	104	EVERY STOREY
121B	15	38	52	90	EVERY STOREY
121C	15	25	49	74	EVERY STOREY
121D	15	65	39	104	EVERY STOREY
TOTAL		193	179	372	

Standard Flats

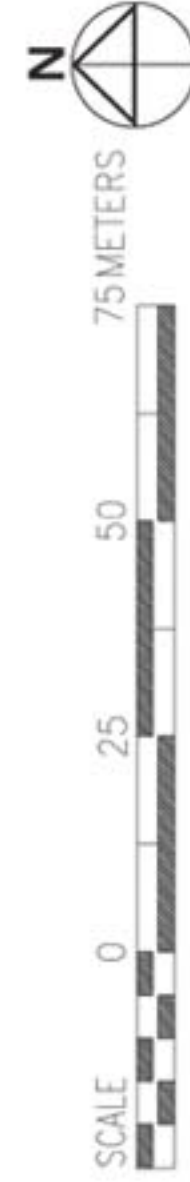

Applicants are encouraged to visit the place before booking a flat.

Unit Distributions

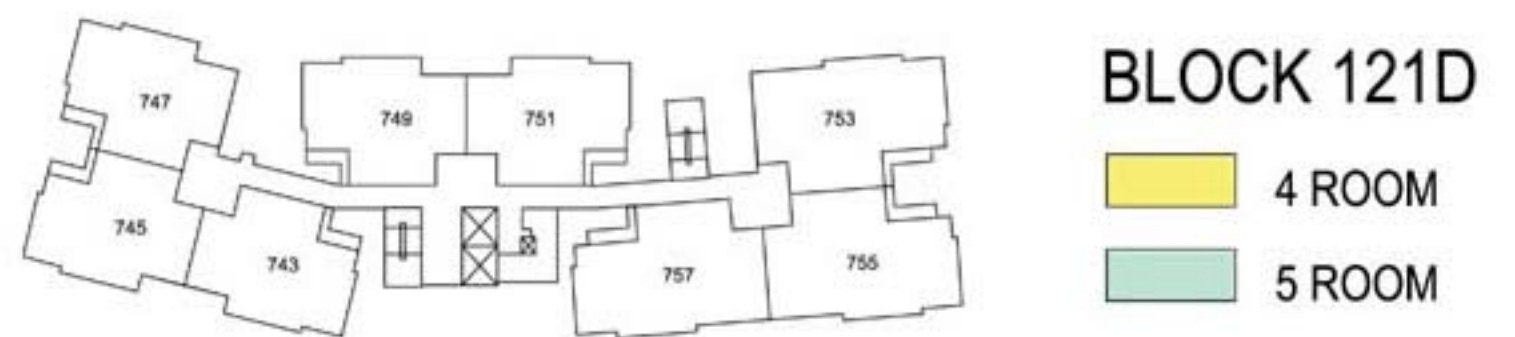
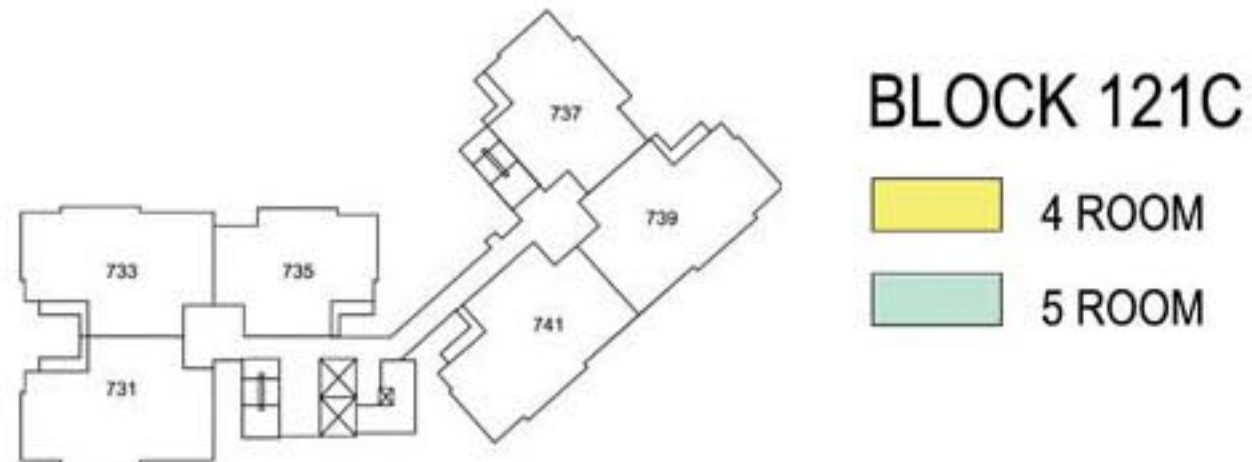
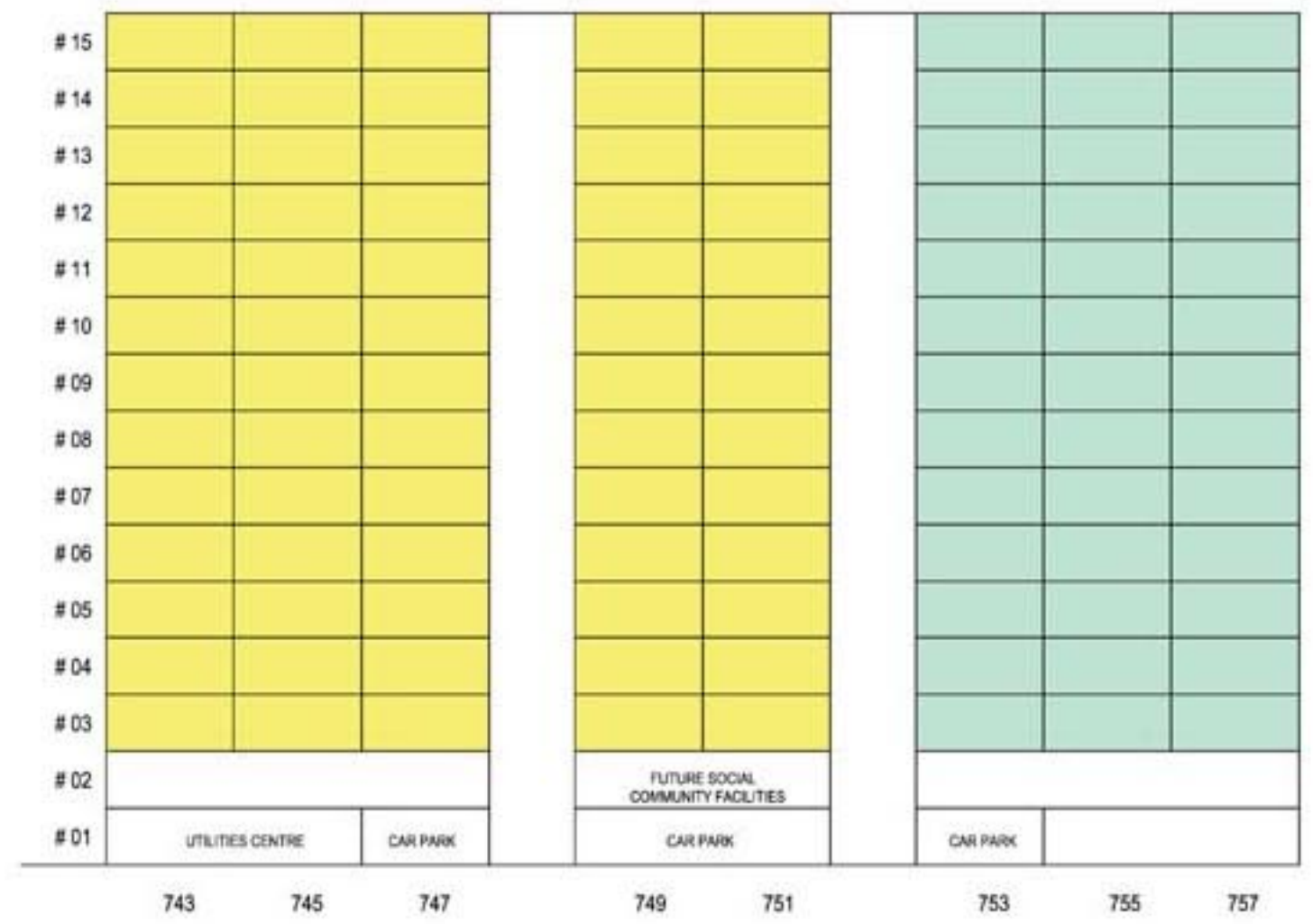
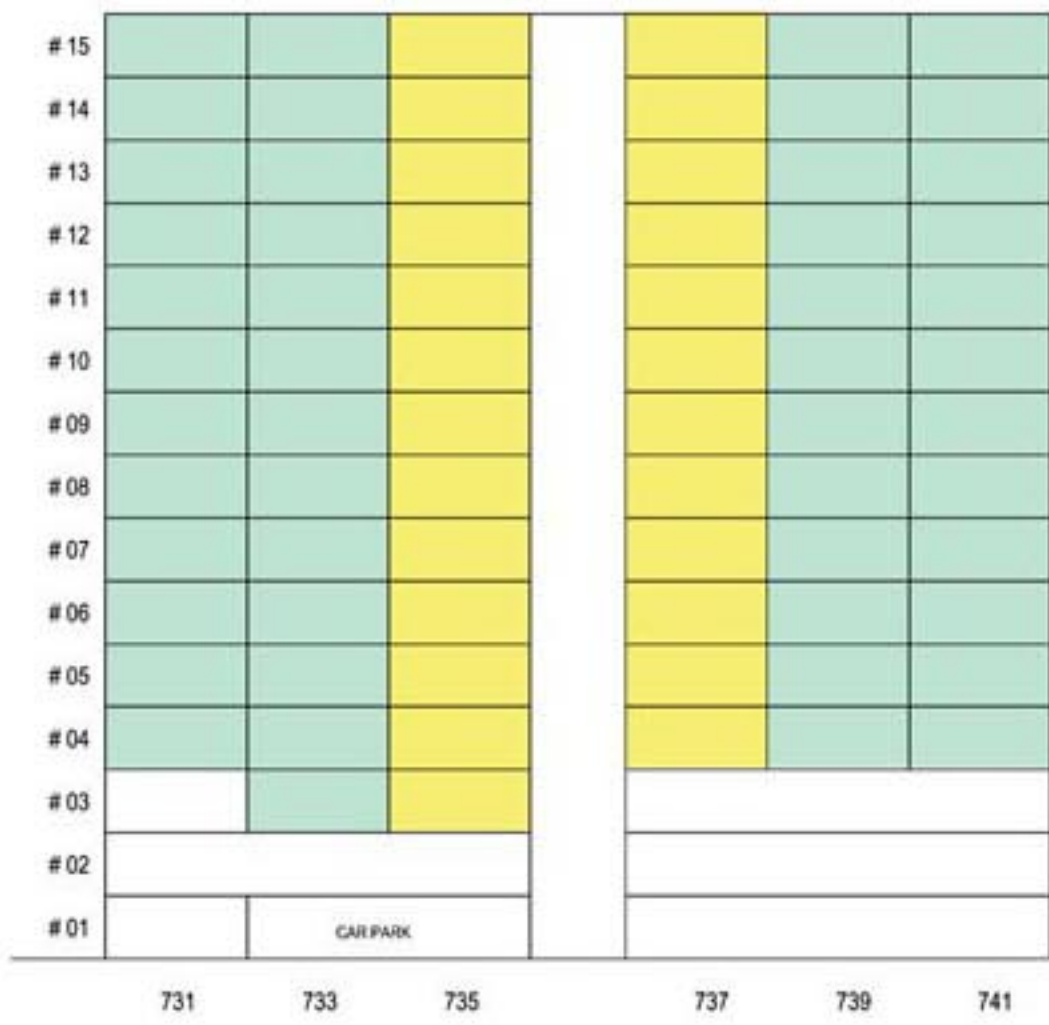
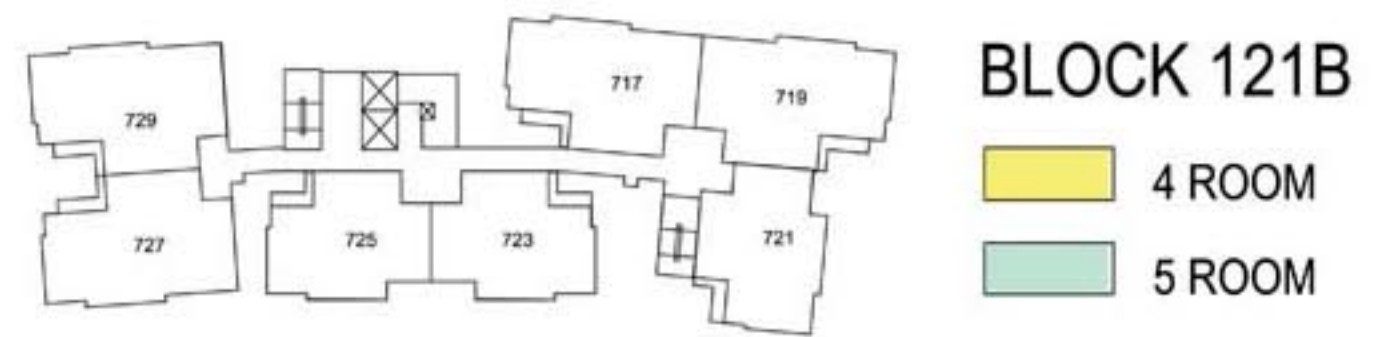
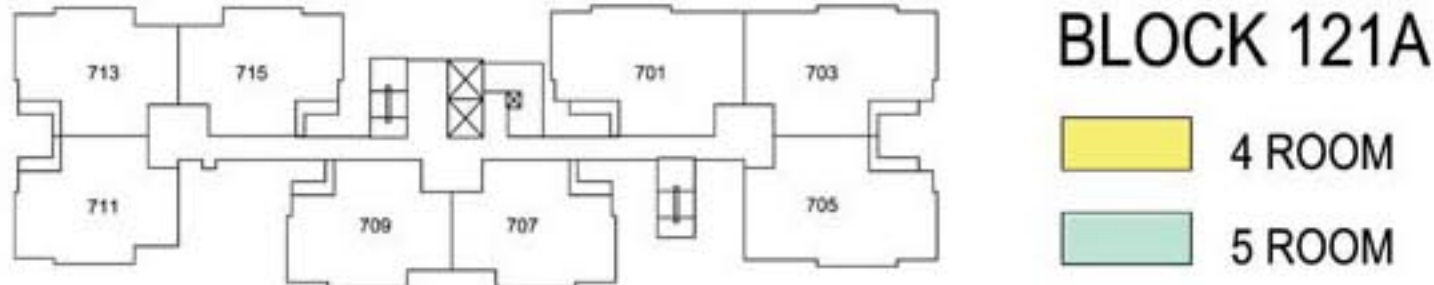
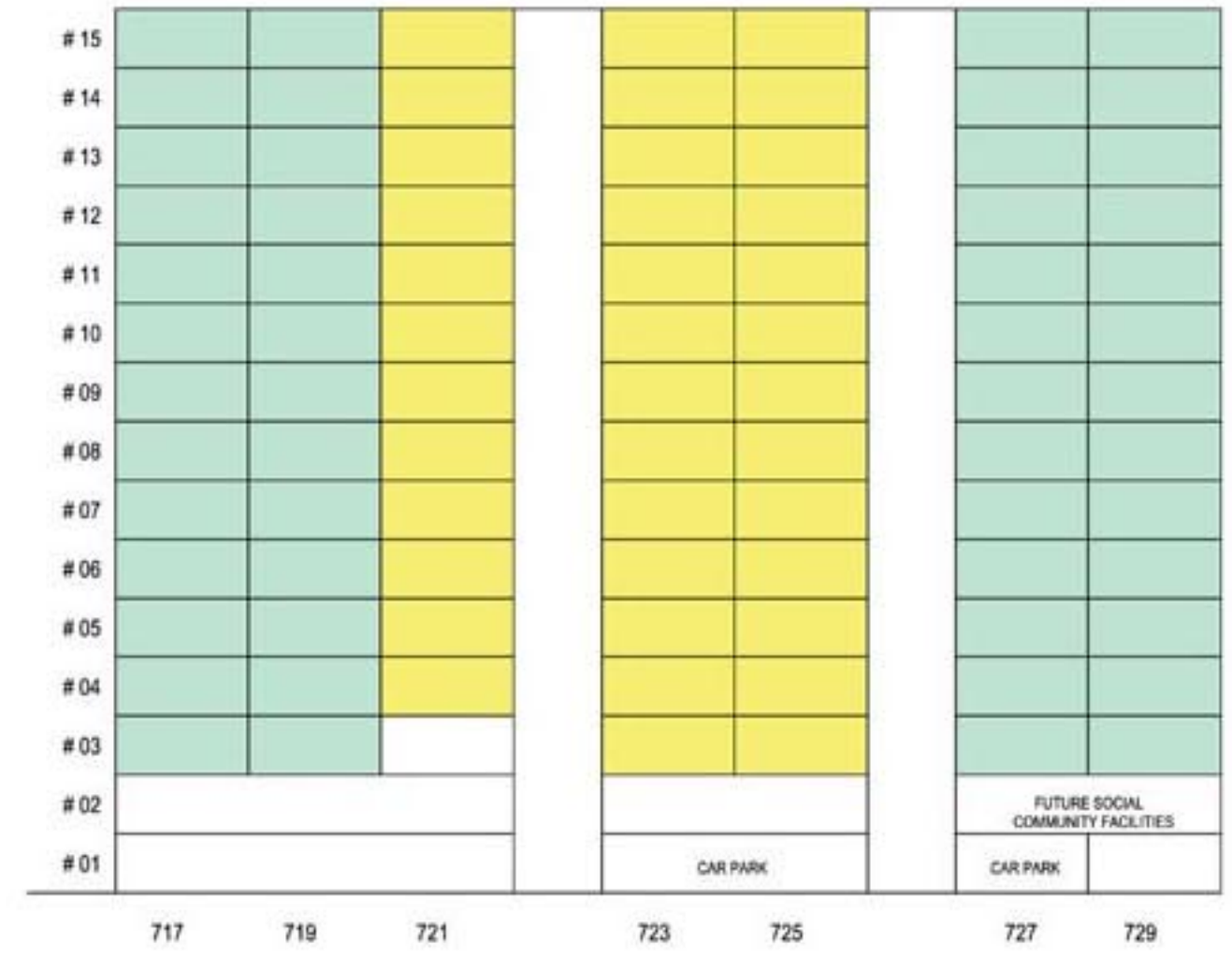

GENERAL SPECIFICATIONS FOR EASTBANK @ CANBERRA

Foundation

Piled foundations.

Structure

Reinforced concrete structural framework with reinforced concrete slabs.

Roof

Reinforced concrete roof slab with precast concrete secondary roofing.

Walls

All external and internal walls are constructed with reinforced concrete/solid blocks/bricks with cement plastering/precast panels/precast lightweight concrete partitions.

Windows

Aluminium framed windows with tinted glass.

Doors

Entrance	: decorative solid timber door and metal gate
Bedroom	: laminated semi-solid timber door (Type D9a) (optional)
Bathroom/WC	: laminated semi-solid timber door (Type D9a) (optional)
Household Shelter	: metal door
Service Yard	: aluminium framed door with glass

Finishes

Ceilings	: skim-coated or plastered and painted
Kitchen/Bathroom/WC walls	: ceramic tiles
Other Walls	: skim-coated or plastered and painted
Living/Dining/Bedroom floor	: polished porcelain tiles with timber skirting (optional)
Kitchen floor	: glazed porcelain tiles
Bathroom/WC floor	: ceramic tiles
Service Yard floor	: glazed porcelain tiles with tile skirting
Household Shelter floor	: glazed porcelain tiles

Fittings

Quality locksets.
Water closet suite.
Vanity top wash basin at attached Bathroom/ WC (for 5-Room only), wash basin for other Bathroom/WC (optional).
Bath/Shower mixer with shower set, tap mixer (optional).
Clothes Drying Rack.

Services

Gas services and concealed water supply pipes.
Concealed electrical wiring to lighting and power points (including water heater and air-conditioning points).
Television points.
Telephone points.

Important Notes:

- 1) The Household Shelter is designed for use as civil defence shelter. The walls, ceiling, floor and door of the Household Shelter shall not be hacked, drilled, altered or removed.
- 2) Air-con panel in the main bedroom will not be provided.
- 3) Any unused or unoccupied open spaces in front of or nearby / adjacent to the flat units are not available for purchase and that the HDB will not entertain any requests from the flat owners to purchase and / or enclose the unused or unoccupied open spaces.

You are advised to visit HDB's website at www.hdb.gov.sg for information on renovations rules.